

# Type H3F Load Cell



## Short description

- Nickel plated alloy steel IP67 "S" type load cell
- Tension and compression applications
- Suitable for hanging, hopper and other weighing devices
- Also available in imperial capacities and dimensions



Non OIML approved



Certificate no. 06-099A1

## Available models

Capacity	Accuracy	Full article description
100kg	C3	H3F-C3-100kg-6T
250kg	C3	H3F-C3-250kg-6T
500kg	C3	H3F-C3-500kg-6T
750kg	C3	H3F-C3-750kg-6T
1t	C3	H3F-C3-1t-6T
1.5t	C3	H3F-C3-1.5t-6T
2t	C3	H3F-C3-2t-6T
2.5t	C3	H3F-C3-2.5t-6T
5t	C3	H3F-C3-5t-6T

Specifications and dimensions are subject to change without notice and do not constitute any liability whatsoever.

# Type H3F Load Cell

## Detailed specifications H3F

Accuracy class		C3
Output sensitivity ( = FS )	mV/V	3.0 ± 0.008
Maximum capacity ( E <sub>max</sub> )	t	0.1, 0.25, 0.5, 0.75, 1, 1.5, 2, 2.5, 5
Max.number of load cell intervals	n <sub>LC</sub>	3000
Ratio of min. LC verification interval	$Y = E_{max} / v_{min}$	10000
Combined Error	%FS	≤± 0.020
Minimum dead load	Of E <sub>max</sub>	0%
Safe overload	of E <sub>max</sub>	150 %
Ultimate overload	of E <sub>max</sub>	300 %
Zero balance	of FS	< ± 1.0 %
Excitation, recommended voltage	V	5 ~ 12
Excitation maximum	V	18
Input resistance	Ω	350 ± 3.5
Output resistance	Ω	351 ± 2.0
Insulation resistance	MΩ	≥5000 ( at 50VDC )
Compensated temperature	°C	-10 ~ +40
Operating temperature	°C	-35 ~ +65
Storage temperature	°C	-40 ~ +70
Element material		Nickel plated alloy steel
Ingress Protection (acc. to EN 60529)		IP67
Recommended torque on fixation	Nm	M10: 50    M12:75    M18: 300
ATEX classification (optional)		II1G Ex ia II1C T4    II1D Ex iaD 20 T73°C    II3G nL IIC T4

## Wiring

### Wiring:

Shielded, 4 conductor cable.  
 Cable diameter: Ø5mm.  
 Standard cable length: 6m.  
 Shield not connected to element

### 4-wire diagram

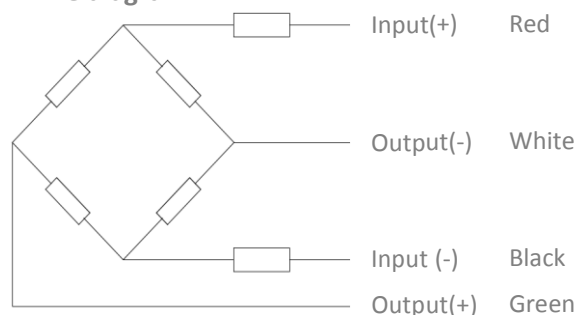

Specifications and dimensions are subject to change without notice and do not constitute any liability whatsoever.

# Type H3F Load Cell

Dimensions in mm

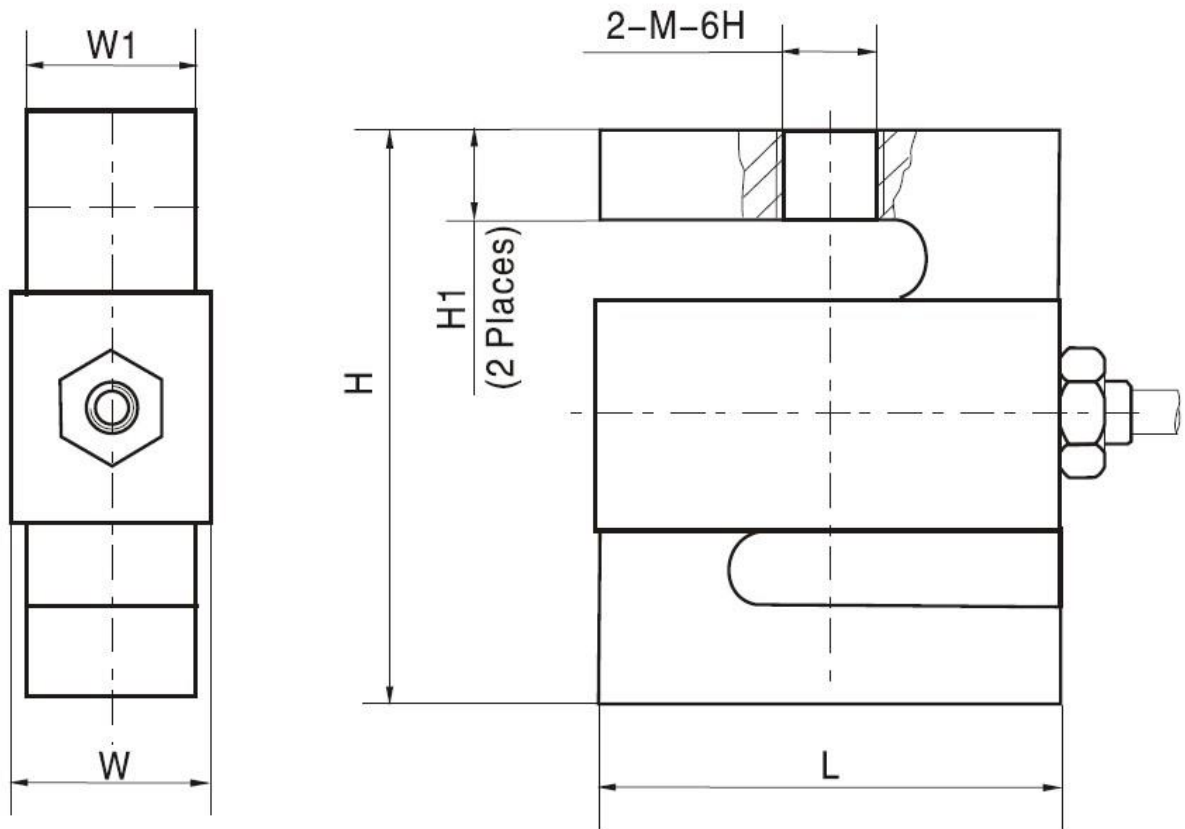

Dimension Capacity	H	W	W1	L	H1	M
100kg	76.2	20.6	19	50.8	15.8	M10 x 1.5
250kg	76.2	20.6	19	50.8	15.12	M12 x 1.75
500kg	76.2	20.6	19	50.8	14.2	M12 x 1.75
750kg	76.2	20.6	19	50.8	13.46	M12 x 1.75
1t	76.2	27	25.4	50.8	13.24	M12 x 1.75
1.5t	76.2	27	25.4	50.8	11.82	M12 x 1.75
2t	108	27	25.4	76.2	26.7	M18 x 1.5
2.5t	108	27	25.4	76.2	25.48	M18 x 1.5
5t	108	27	25.4	76.2	20.26	M18 x 1.5

Specifications and dimensions are subject to change without notice and do not constitute any liability whatsoever.

# Type H3F Load Cell

## Available accessories

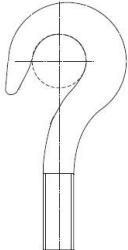
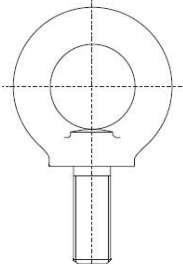
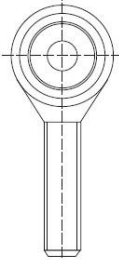
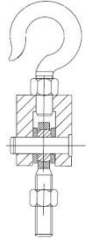
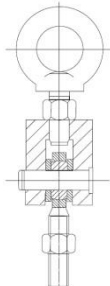
<p><b>HL-3-001-25kg-5t hook</b></p> <ul style="list-style-type: none"> <li>• Alloy Steel</li> <li>• Suitable for hybrid scales, crane scales, packaging scales and hopper scales</li> </ul>	
<p><b>HL-3-002-25kg-5t eye</b></p> <ul style="list-style-type: none"> <li>• Alloy Steel</li> <li>• Suitable for hybrid scales, crane scales, packaging scales and hopper scales</li> </ul>	
<p><b>HL-3-003-25kg-5t rod end</b></p> <ul style="list-style-type: none"> <li>• Alloy Steel</li> <li>• Suitable for hybrid scales, crane scales, packaging scales, hopper scales and other electronic weighing devices.</li> </ul>	
<p><b>HL-3-004-25kg-5t hook assembly</b></p> <ul style="list-style-type: none"> <li>• Alloy Steel</li> <li>• Suitable for hybrid scales, crane scales, packaging scales, hopper scales and other electronic weighing devices.</li> </ul>	
<p><b>HL-3-005-25kg-5t eye assembly</b></p> <ul style="list-style-type: none"> <li>• Alloy Steel</li> <li>• Suitable for hybrid scales, crane scales, packaging scales, hopper scales and other electronic weighing devices.</li> </ul>	

Specifications and dimensions are subject to change without notice and do not constitute any liability whatsoever.